

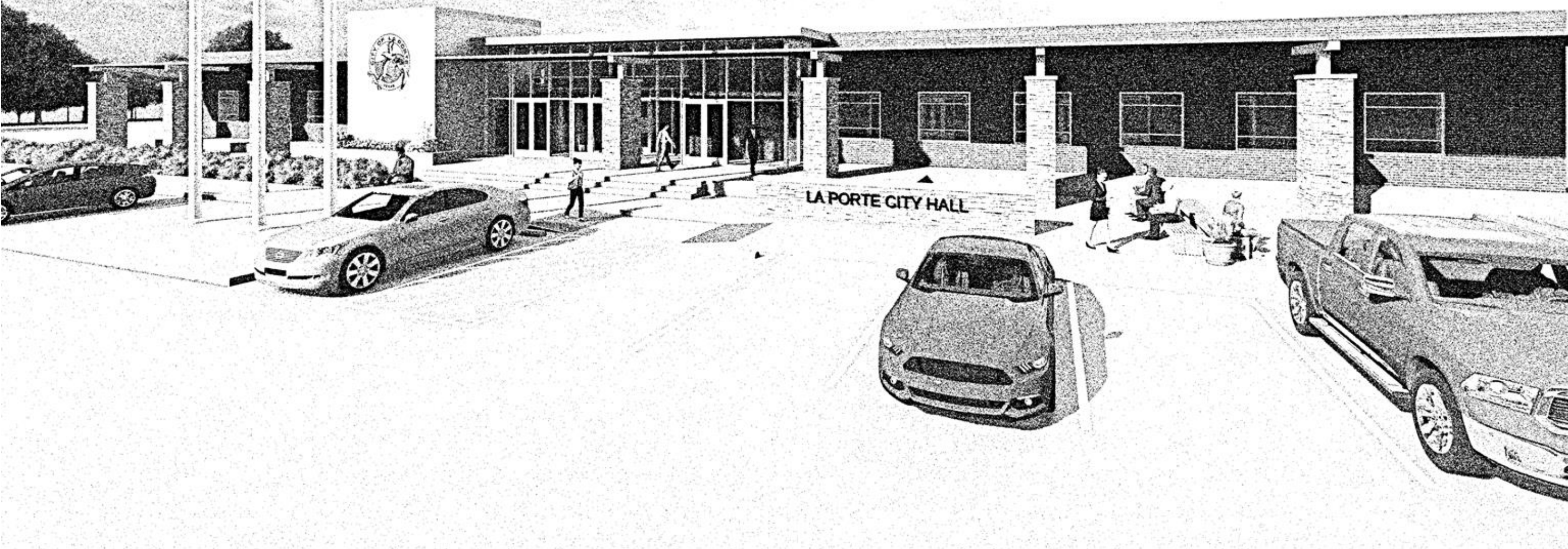

# LA PORTE TEXAS



**JOINER**  
ARCHITECTS

## LA PORTE CITY HALL

**DESIGN STUDY**



## Mayor & Council

Mr. Rick Helton	Mayor
Mr. Brandon Lunsford	At-Large A
Mr. Brent McCaulley	At-Large B
Ms. Mandi Williams	District 1
Mr. Chuck Engelken	District 2
Mr. Bill Bentley	District 3
Vacant	District 4
Mr. Jay Martin	District 5
Mr. Robbie McLarrin	District 6

## Administration

Mr. Corby Alexander	City Manager
Mr. Matt Daeumer	Assistant City Manager

## Public Works

Mr. Ray Mayo	Director of Public Works
Mr. Jameson Appel	Assistant Director of Public Works

## Engineering

Mr. Lorenzo Windgate	City Engineer
----------------------	---------------

## Department Heads

Mr. Lee Woodward	City Secretary
Mr. Michael Dolby	Director of Finance
Ms. Teresa Evans	Director of Administration
Mr. Matt Hartleib	Human Resources Manager
Mr. Clif Meekins	Fire Marshal

The Principals and staff of Joiner Architects wish to express our sincere appreciation to The City of La Porte for allowing our Firm the opportunity to be involved in the Design Study to renovate and rejuvenate the existing aging City of La Porte City Hall, and completely transform the current facility into a new and modernized City Center. It has been a pleasure thus far, and we look forward to the future opportunity to advance this project further.

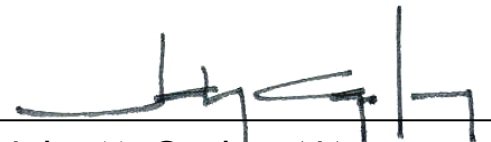
A handwritten signature in black ink, appearing to read "Joby M. Copley".

Joby M. Copley, AIA  
Partner/Project Architect

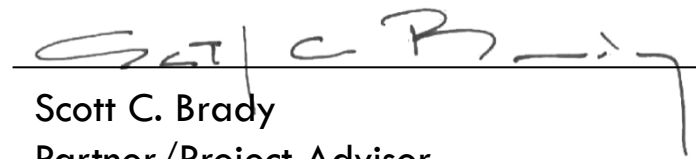
A handwritten signature in black ink, appearing to read "Scott C. Brady".

Scott C. Brady  
Partner/Project Advisor

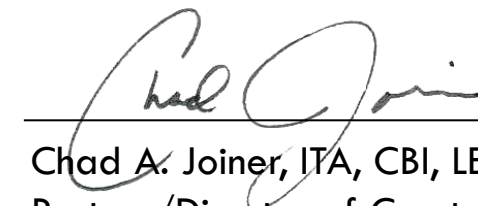
A handwritten signature in black ink, appearing to read "Chad A. Joiner".

Chad A. Joiner, ITA, CBI, LEED GREEN ASSOCIATE  
Partner/Director of Construction



# Existing Site Aerial Image



**LEGEND:**

1. EXISTING CITY HALL
2. ENTRANCE PLAZA
3. EXISTING PARKING LOT
  - 118 PARKING STALLS
  - 6 ADA PARKING STALLS
4. GENERATOR & DUMPSTER YARD
5. ONE WAY DRIVE THROUGH TRANSACTION WINDOW
6. EXISTING GREEN SPACE

N







### LEGEND:

1. RENOVATED CITY HALL 33,900 SF
  - 28,385 SF RENOVATIONS
  - 5,515 SF ADDITIONS
2. ENTRANCE PLAZA
3. RENOVATED PARKING LOT
  - 126 PARKING STALLS
  - 6 ADA PARKING STALLS
4. GENERATOR & DUMPSTER YARD
5. ONE WAY DRIVE THROUGH TRANSACTION WINDOW
6. EXISTING GREEN SPACE
7. DETENTION POND

# Floor Plan

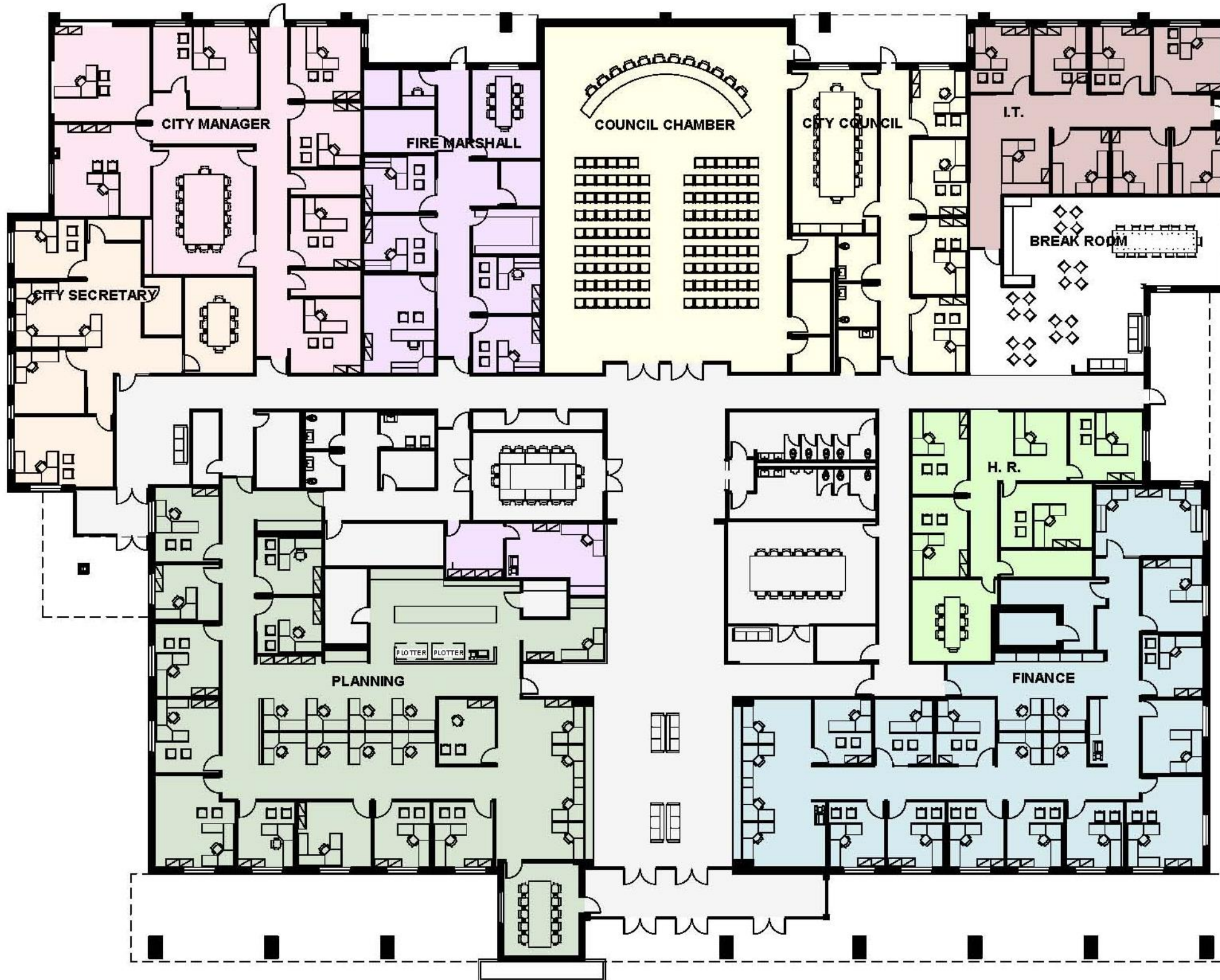

## LEGEND

	CITY COUNCIL	3,154 SF
	CITY MANAGER	2,813 SF
	CITY SECRETARY	1,461 SF
	H.R. DEPARTMENT	1,172 SF
	I.T. DEPARTMENT	1,528 SF
	FINANCE DEPT.	3,648 SF
	PLANNING DEPT.	4,896 SF
	FIRE MARSHAL	1,887 SF
	SHARED SPACE	12,823 SF
	<b>AREA TOTAL</b>	<b>33,390 SF</b>

N









# Anticipated Total Project Cost



Construction (33,390 SF x \$450)	\$	15,025,500
Architectural & Engineering Design Fees	\$	1,140,000
Traffic Impact Analysis (If Required)	\$	8,000
Geotechnical Study	\$	25,000
Site Surveying	\$	20,000
Windstorm Certification	\$	10,000
Construction Material Testing	\$	50,000
Accessibility Review & Inspection	\$	3,000
Fixtures, Furniture & Equipment	\$	900,000
HVAC System Testing & Balancing	\$	25,000
Building System Commissioning	\$	18,000
Temporary Office Building Allowance	\$	800,000
Owner's Contingency Allowance	\$	750,000
Design Contingency/Material Escalation	\$	1,200,000
<b>TOTAL ANTICIPATED PROJECT COST</b>	<b>\$</b>	<b>19,974,000</b>



